

- 1、 All dimensions in mm [Inch]
- 2、 General tolerance : >10±0.4  
<10±0.25
- 3、 Electrical rating : 16A 250VAC & 20A 125VAC(UL) & 16A 250VAC(ENEC)
- 4、 Contact resistance : <20mΩ(Initial)
- 5、 Insulation resistance : >1000MΩ(500VDC between open contacts)
- 6、 Dielectric strength : >1500V 1 minute
- 7、 Mechanical life : >30000 cycles
- 8、 Electrical life : >10000 cycles
- 9、 Temperature rise at the terminal : Max.30℃
- 10、 Solder ability of terminal: Max350℃,3S(no pressure may be placed in the terminals when soldering by hand)
- 11、 Any Cd Pb Hg etc and it's compounds is not include in this product
- 12、 Ambient temperature: T105/55
- 13、 Ambient humidity: Max.85%
- 14、 Appicability for appliance of class: class II
- 15、 Proof tracking resistance index(PTI): 175
- 16、 Degree of pollution: normal

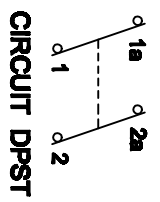

POLE FUNCTION	OPTIONS OF FUNCTION	
A	—	B
DPST	1-1a 2-2a	OFF

PANEL OUT-CUT			
Z	Y	X	
0.7~1.25 [.028~.049]	21.7~21.8 [.854~.858]	30.0~30.2 [1.181~1.189]	
1.25~2.0 [.049~.079]	21.7~21.8 [.854~.858]	30.2~30.4 [1.189~1.197]	
2.0~3.0 [.079~.118]	21.7~21.8 [.854~.858]	30.0~30.8 [1.205~1.213]	

• We keep the right to alter the dimension without notice.

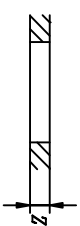
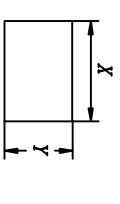
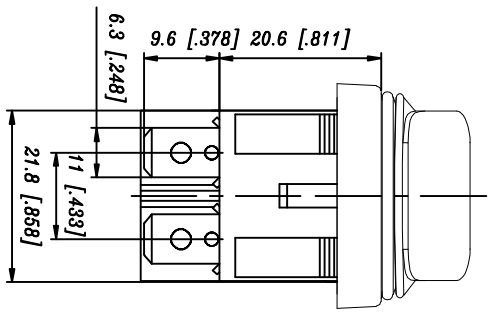
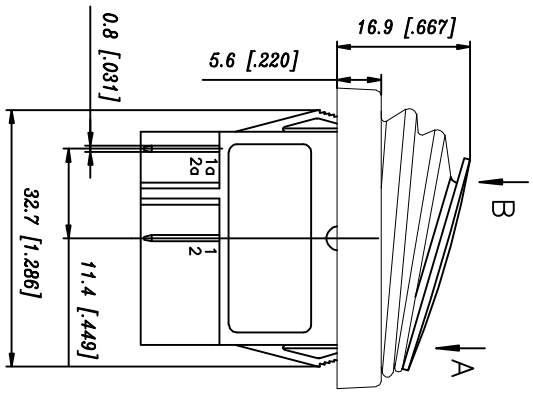
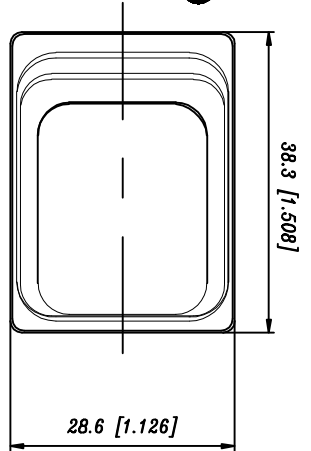

SCALE:0.6:1

Part NO.	R515	T0EFH	LIGHT COUNTRY CO., LTD								
Dwg. NO.	R515-200525		A	B	C	D	E	F	G	H	I
Series NO.	R5		•	—	—	—	—	—	—	△	ON
Dwg. Name	Specification		○	○			○	○	○	▽	OFF

Color	Housing	Actuator
K(Black)		
W(White)		
R(Red)		
G(Gray)		
O(Orange)		
B(Blue)		
Y(III. Yellow)		
M(II. Green)		
F(II. Blue)		
T(III. White)		
D(III. Red)		

Part NO.	R515	T0EFH	 LIGHT COUNTRY CO., LTD
Dwg. NO.	R515-200525		
Series NO.	R5		Drawing
Dwg. Name	Specification	Scale	Jiangshengxian
		1.5:1	Auditing
		Date	luyanchao
		05/25/20	Page